

FOREST
DRAPERY HARDWARE



**MANUAL
OPERATION**

FOREST DS[®] *Design System*

Elegant hand drawn system for all types of light to medium weight draperies.

THE WORLD *BEHIND*
your **DRAPERIES...**

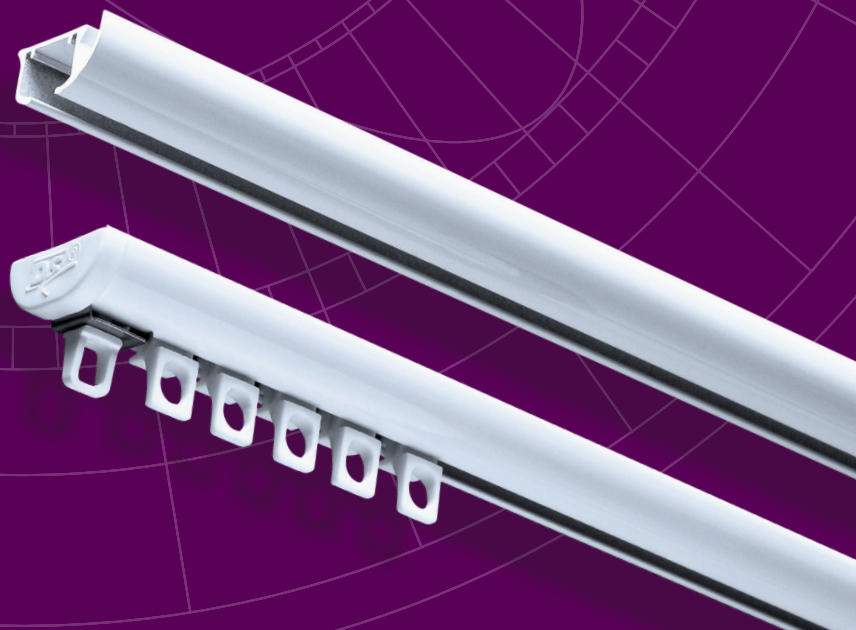

FOREST DS®



PRODUCT INFORMATION

- Elegant and aesthetically pleasing hand drawn system for all types of light to medium weight draperies.
- Quick installation with “Smart Klick” brackets for wall and ceiling applications.
- Hidden brackets are behind the elegant shape of the track.
- Heavy duty clickable carriers are UV protected and offer smooth, easy traversing.
- Can be used with pinchpleat, ripplefold and accordiafold draperies.
- Recommended maximum fabric weight is 3 lbs./ft.
- Track finish is a chromated powder coating with a factory applied patented dry lubricant.
- Limited lifetime warranty.

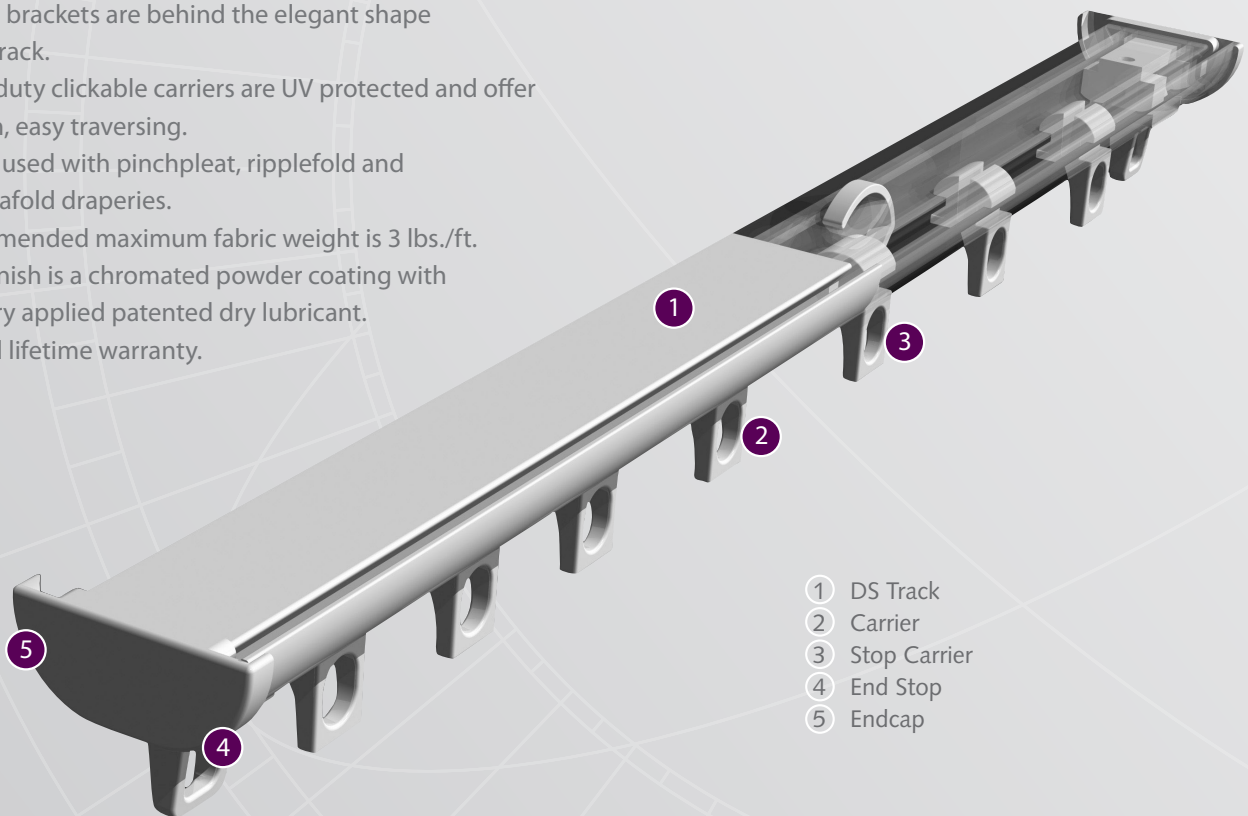

- ① DS Track
- ② Carrier
- ③ Stop Carrier
- ④ End Stop
- ⑤ Endcap



PROFILE

- Aluminum Extrusion
- Dimensions: 1 1/4" x 1/2"

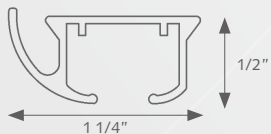

FOR USE IN

Hotels, motels, offices, schools, healthcare facilities, residences or at any location where an elegant hand drawn system is desired.

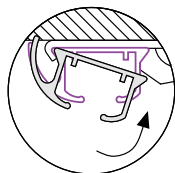

Easy installation
click - position - tighten

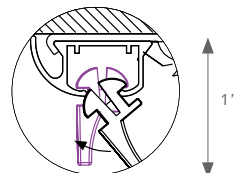

clickable carrier

APPLICATIONS

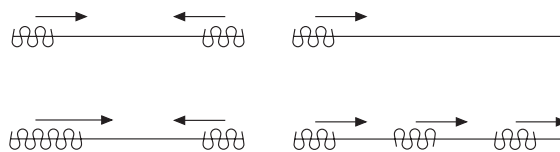

MOUNTING BRACKETS

Brackets need to be placed every 24".

Heavy Duty Ceiling Bracket with Smart Klick 3003-XX

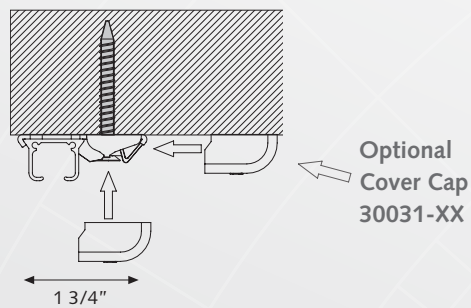

3" Smart Klick Wall Bracket 53202-XX

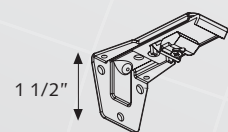

6" Smart Klick Double Wall Bracket 53206-XX

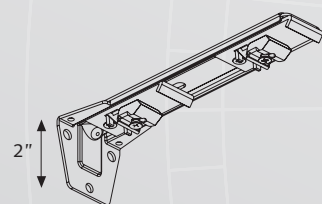

3" Wall Bracket for Wood Poles 3280-XX

A) 3" B) 2 1/2"

A) 5" B) 4 1/2"

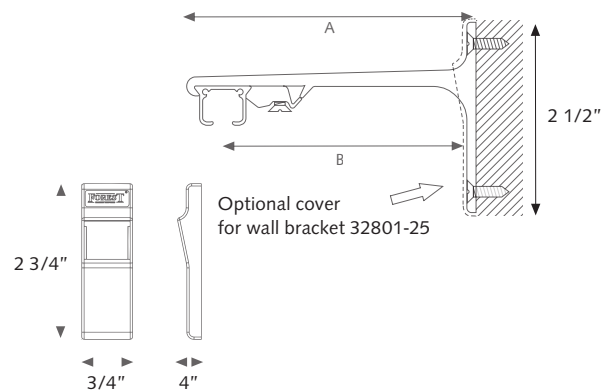

6" Double Wall Bracket for Wood Poles 3281-XX

A) 6" B) 3 5/8" C) 1 3/4"

A) 8" B) 3 5/8" C) 3 3/4"

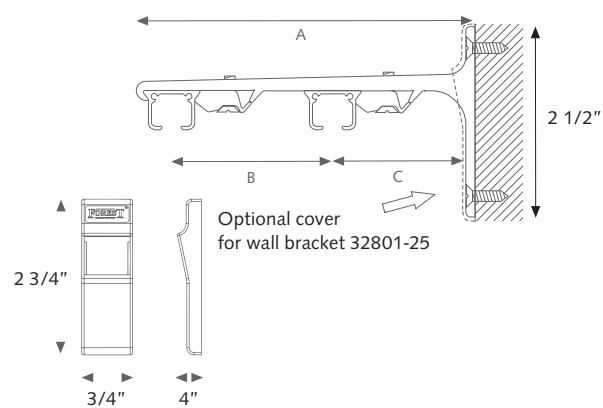

10" Triple Wall Bracket for Wood Poles 3284-25

A) 10" B) 3 3/4" C) 2"

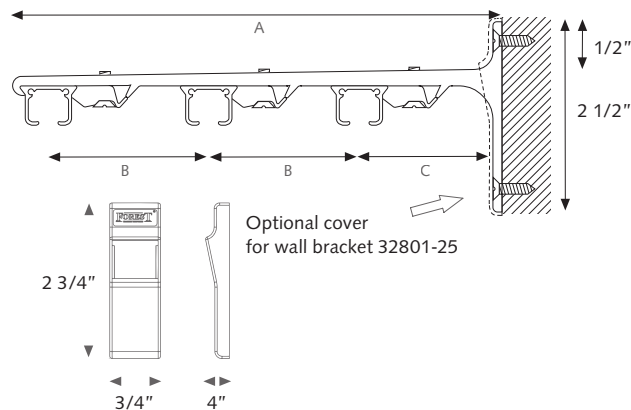

DS CARRIERS



2001-25
-59 Black, -65 Brown,
-90 Silver
Click Carrier
for pinch pleat
box of 500



2002-25
-59 Black, -65 Brown,
-90 Silver
Shirrtape Carrier
box of 500



2003-25
-59 Black
Stop Carrier
Clickable
Prevents slide back
box of 250



2004-25
-59 Black
Snap Carrier
for accordiafold
box of 500

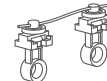

2114-25 60% fullness, 2 5/8" OC
2111-25 80% fullness, 2 3/8" OC
80% Only -65 Brown, -90 Silver
2112-25 100% fullness, 2 1/8" OC
2115-25 120% fullness, 1 7/8" OC
All Fullnesses -59 Black
Two-Piece Connected Snap Carrier
w/ Square Base
In plastic sleeve. Use 4 1/4" snap tape
roll of 500



52003-25
-65 Brown
Economy Slide
box of 2000



52005-25
Button Slide Carrier
box of 1000



52105-25
Button Slide Carrier
w/ Hook
bag of 500

DS MASTERS

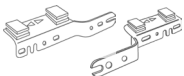

2525-25 Overlap R
2526-25 Underlap L
2527-25 Overlap L
2528-25 Underlap R
Universal Low Profile Master
box of 25



2540-25 Overlap R
2541-25 Underlap L
Low Profile Snap Master
for straight track only
box of 100

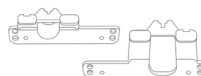

B8809-23-00 Overlap R
B8809-24-00 Underlap L
Plastic Snap Master
box of 25

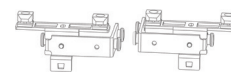

52410-25 Butt R
52409-25 Butt L
Standard Butt Master
w/ snaps
for use with baton
box of 50

DS BRACKETS



3001-25
Regular Duty Ceiling
box of 100



3002-25
Klick On Ceiling
with steel spring clip
for use with drop ceilings
box of 100



3003-25
Heavy Duty Ceiling
w/ Smart Klick
box of 100



30031-25
Ceiling Bracket Cover
use with 3003-25
box of 100

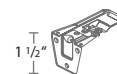

53202-25
3" Smart Klick
Wall Bracket w/ wide base
adjusts 3"-4 1/2"
box of 100

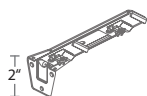

53206-25
6" Smart Klick Double
Wall Bracket w/ wide base
adjusts 2 1/2-4" & 6-7 1/2"
box of 50



3280-25
3" Wall Bracket
heavy duty
projection 2 1/2"
box of 20

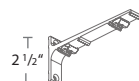

3281-25
6" Double Wall Bracket
heavy duty
projection 1 1/2", 5 1/2"
box of 15

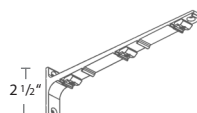

3284-25
10" Triple Wall Bracket
heavy duty
projection 2", 6 5/8",
9 5/16"
box of 10



32801-25
Wall Bracket Cover
**use with 53202, 53206
& 3280**
box of 10

DS OTHER COMPONENTS



3905-25
Track Connector and key
3904-00
box of 50



2305-25
Twist On End Stop
box of 100



2310-25
DS End Cap w/ screw
box of 10



54110-25
36" Fiberglass Baton
w/ snap
box of 100