

### 3. Coronado Loop Control Headrail

#### Inside Mount - Attaching the Brackets

- Hold Coronado shade inside the window frame. Center shade so space between end of the headrail and edges of the window frame are equal.
- Use a pencil to mark the position of ends of the headrail inside the window frame. Mount brackets so the centers are 4 1/2" in from each mark. (See page 1)
- Each bracket requires two screws (provided).



#### Outside Mount - Attaching the Brackets

- Center Coronado shade over window opening at the desired height, making sure shade is level.
- Mark the position of ends of headrail on the wall with a pencil. Mount brackets so the centers are 4 1/2" in from each mark. (See page 1)
- Each bracket requires two screws (provided).
- Wider shades may require additional brackets.

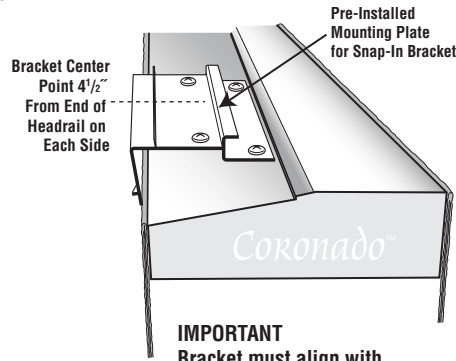

**IMPORTANT**  
Bracket must align with mounting plate on headrail.

\* Screws must hit studs to be secure. If studs are not found, use another type of fastener appropriate for your surface.

#### Attaching Coronado Shade to Brackets

1. Mount Snap-In Brackets to wall using spacing instructions above.
2. Pivot or push headrail toward bracket, applying just enough pressure so that bracket snaps into Mounting Plate securing Coronado shade to bracket.

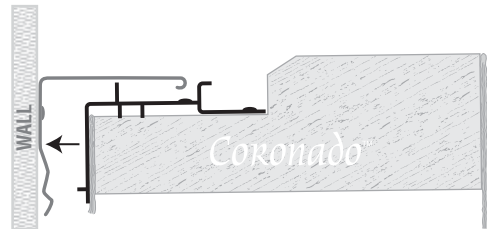

3. Once Shade is locked into Brackets, it is secure on wall. If there is a need to remove the shade, push Release Tabs to unlock Shade from Brackets.

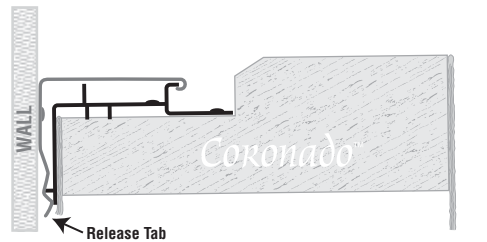

#### Installing Cord Loop Tensioner for Coronado Shades

For Loop Control Shades Only

- After shade has been installed, mount Cord Tensioner in a location that does not impede shade function.
- Shade will not operate unless Cord Tensioner is attached correctly.
- See additional Cord Tensioner instructions provided



## Installation Instructions

# Coronado™

Natural Woven Shades



### Coronado Standard Headrail See Section 1

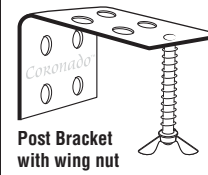

Post Bracket with wing nut



Cord Cleat For Standard Headrail

#### Standard Headrail

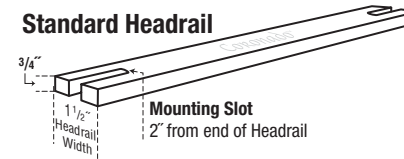

#### Standard Wider Headrail For use with Dual Shades and Cordless

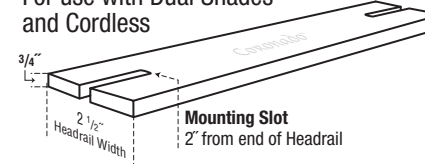

#### Cord Control Location

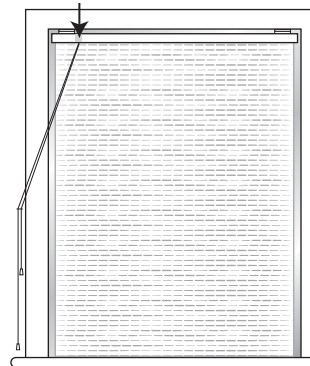

### Coronado Loop Control Headrail See Section 3

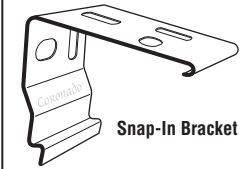

Snap-In Bracket

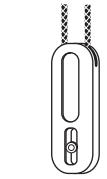

Cord Tensioner For Loop Control Headrail

#### Loop Control Headrail

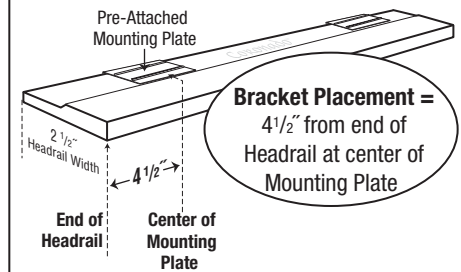

**Bracket Placement =**  
4 1/2" from end of Headrail at center of Mounting Plate

#### Loop Control Location

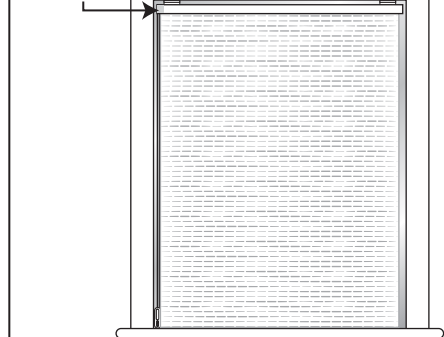

# Installation Instructions

Please read instruction before you start installation.

It is recommended that shades and cords remain in shipping position until after installation is completed. This will prevent cords from tangling during installation.

## 1. Standard Coronado Headrail

### Attaching the Brackets

#### For an inside mount (figure 1-A)

- Hold Coronado shade inside the window frame.
- Center shade so space between end of the headrail and edges of the window frame are equal.
- Attach brackets with the screws provided.

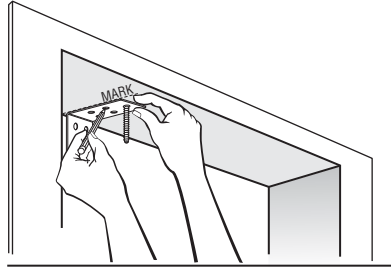

Figure 1-A (Inside Mount)

### Attaching the Brackets

#### For an outside mount (figure 1-B)

- Center Coronado shade over window opening at desired height, making sure the shade is level.
- Mark position of the ends of headrail on wall with a pencil.
- Attach brackets with the screws provided.

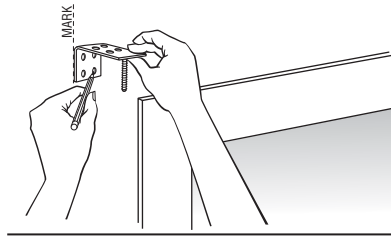

Figure 1-B (Outside Mount)

### Attaching Coronado Shade to Brackets

#### Standard Headrail Mount (figure 1-C)

- With the brackets installed and level with one another, remove wing nuts from threaded posts and place the shade onto the brackets.
- With threaded posts coming through mounting slots on each end of headrail, reinstall the wing nuts onto the threaded posts and hand tighten.

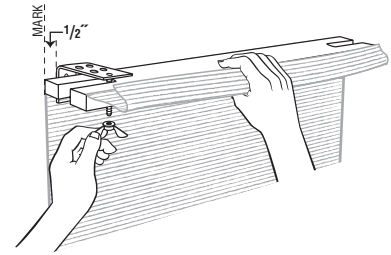

Figure 1-C (Attaching Shade to Bracket)

## 2. Upended Coronado Headrail

Shade attaches directly to wall or top inside of window frame.  
No Bracket required.

### For an inside mount (figure 2-A)

- Hold Coronado shade inside the window frame. Center shade so space between ends of the headrail and edges of the window frame are equal.
- With shade properly positioned, attach shade with the long screws provided. Headrail is pre-drilled to accommodate long screws provided. Hold shade fabric out of the way and attach headrail as shown. Pre-drilling the mounting surface is recommended.

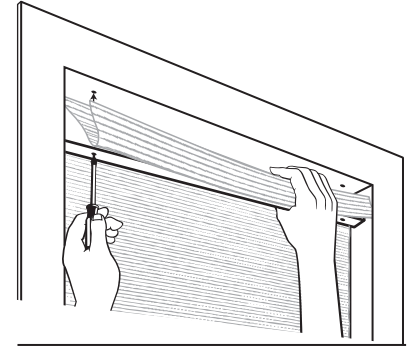

Figure 2-A (Inside Mount)

### For an outside mount (figure 2-B)

- Center Coronado shade over window opening at desired height. Make sure shade is level and centered above the window.
- Push the shade back against wall and attach with screws provided. Headrail is NOT pre-drilled. Screw location is determined by installer.
- Be sure the screws and moving drill parts do not catch shade fabric or cords during installation. (Pre-drilling the mounting surface is recommended).

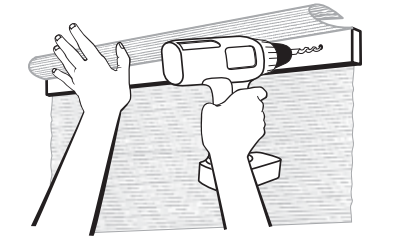

Figure 2-B (Outside Mount)

\* **NOTE:** For Flat Fold shades, when inserting screws through the headrail you will need to push through material in order to properly mount the shade.

### Cord Cleat For Standard Headrail

For shades without Loop Control

- When shade is in the raised position, cords may hang within reach of children and pets causing a hazardous situation.
- Attach Cord Cleat to wall and secure cords to the cleat so that they are out of reach of children and pets.

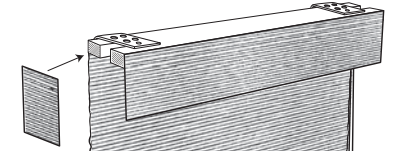

### Coronado Valance Returns

For all outside mount styles

- Coronado shades have side returns to cover exposed ends of headrail. Attach side returns with velcro provided.

### Hold Down Bracket (Optional)

- Use this option when installing shades on a door to keep shade from swinging when door is opened or closed.
- To install, insert Hold Down pin into each end of shade hem dowel. Lower the shade completely. Mark desired Hold Down location. Attach Hold Down with screws provided.
- For Coronado shades with edge banding, velcro is used in place of hold down bracket.

